

V-3AM 1000WOG

3PC STAINLESS STEEL 316 BALL VALVE



4" FULL PORT



1/2"-3" FULL PORT

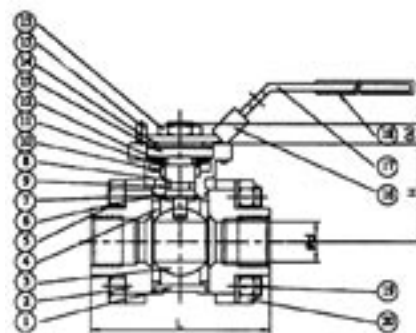
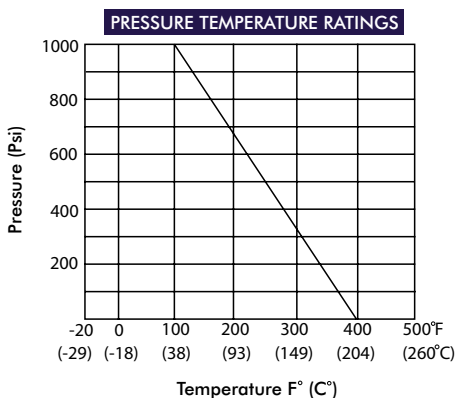
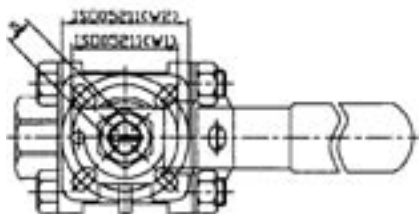

SIZE	Ød	L	H	h	S	W1	W2	ISO-5211	TORQUE IN/LB
3/8"	12.5	65.5	38	7	9	36	42	F03/F04	28
1/2"	15.0	65.5	38	7	9	36	42	F03/F04	40
3/4"	20.0	77.6	42.4	9	9	36	42	F03/F04	72
1"	25.0	83.5	48.5	12	11	42	50	F04/F05	95
1 1/4"	32.0	102.5	54	12	11	42	50	F04/F05	130
1 1/2"	40.0	117.6	66	16	14	50	70	F05/F07	180
2"	50.0	130.2	74	16	14	50	70	F05/F07	220
2 1/2"	65.0	158.6	100.5	19	17	70	102	F07/F10	300
3"	80.0	177.8	109.8	19	17	70	102	F07/F10	485
4"	100.0	225.2	141	24	17	70	102	F07/F10	840

NO	PARTS NAME	MATERIAL		QTY
		STAINLESS STEEL		
1	BODY	ASTM A351 Gr.CF8M		1
2	CAP	ASTM A351 Gr.CF8M		2
3	BALL	ASTM A351 Gr.CF8M		1
4	SEAT	PTFE		2
5	BOLTS	ASTM A93 Gr.B8M		4-6
6	GASKET	PTFE		2
7	THRUST WASHER	PTFE		1
8	STEM	ASTM A276 Gr.316		1
9	O-RING	VITON		1
10	PACKING	PTFE		1
11	RING	S.S. 304		1
12	BELLEVILLE WASHER	S.S. 410		2
13	HANDLE NUT	S.S. 304		2
14	STEM WASHER	S.S. 304		1
15	SET SCREW	S.S. 304		1
16	LOCKING PLATE	S.S. 304		1
17	HANDLE	S.S. 304		1
18	HANDLE SLEEVE	ASTM A351 Gr.CF8M		1
19	BOLT WASHER	S.S. 304		4-6
20	BOLT NUTS	ASTM A194 Gr.B		4-6

TRANS-VALVE, INC.®

P.O. BOX 94283
 BIRMINGHAM, ALABAMA 35220-4283
 TELEPHONE 205 833-6864
 FAX 205 699-6301

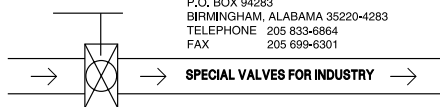

EMAIL: mack4transvalve@earthlink.net
 www.Trans-valve.com